

# eSourcing and MBE

Prepared for MBE Supplier Summit  
Letterkenny Army Depot

DISTRIBUTION STATEMENT B. Distribution authorized to only (proprietary and competition sensitive information) U.S. Government agencies and approved DoD contractors functioning as technical advisors to the Government team. Other requests shall be referred to Air Force Research Laboratory, 2977 Hobson Way, Building 653, Wright-Patterson AFB, OH 45433-7746. Nov 2010.

11/4/2010



# Overview



- What is eSourcing and how does it fit into MBE?
- Past experience at ARDEC
- Next Steps
- Conclusions



# eSourcing: A Definition



A class of computer applications that automates, streamlines and documents the process of selecting a supplier and then obtaining a given product.



# The Model Based Enterprise (MBE) Connection



- eRFIs, eRFQs and POs can reuse and distribute the master model information to the supply chain
- Overall, eSourcing maximizes the reuse of the master model to minimize down stream re-mastering which is the core of MBE

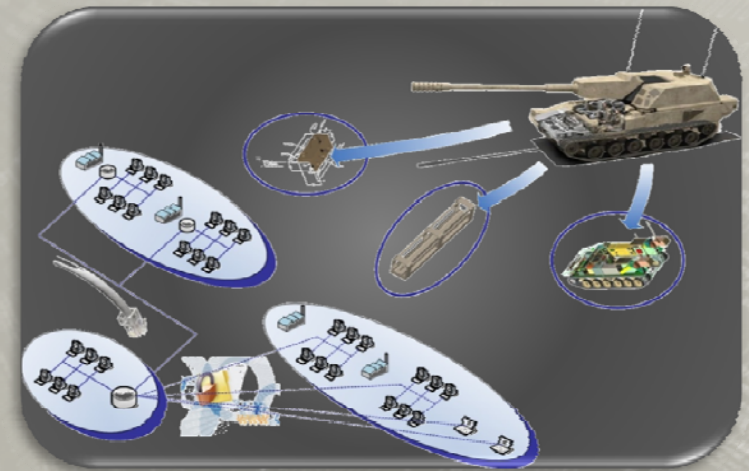

# ARDEC & DLA Pilots



- In 2008 & 2009 the Prototype Process and Material Technology Division at Picatinny Arsenal teamed with the Defense Supply Center Columbus Ohio to pilot the use of a 3D TDP to procure hard to source parts
  - This was based on a re-mastered 3D Model and an updated CAD drawing from a 1930 vintage hand drawing
  - In many cases a generic process definition was created and then distributed with the TDP
- The TDP was also distributed through an eSourcing web portal
  - This tool also aided in source selection and tracked the progress of the parts procurement



# M2 Machine Gun DSCC Parts

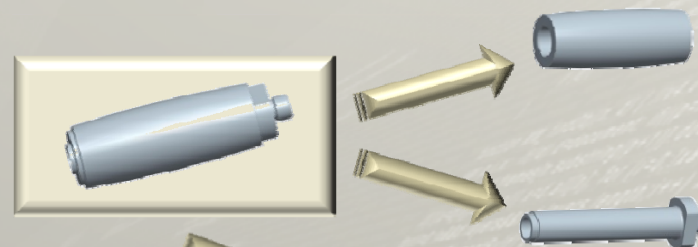
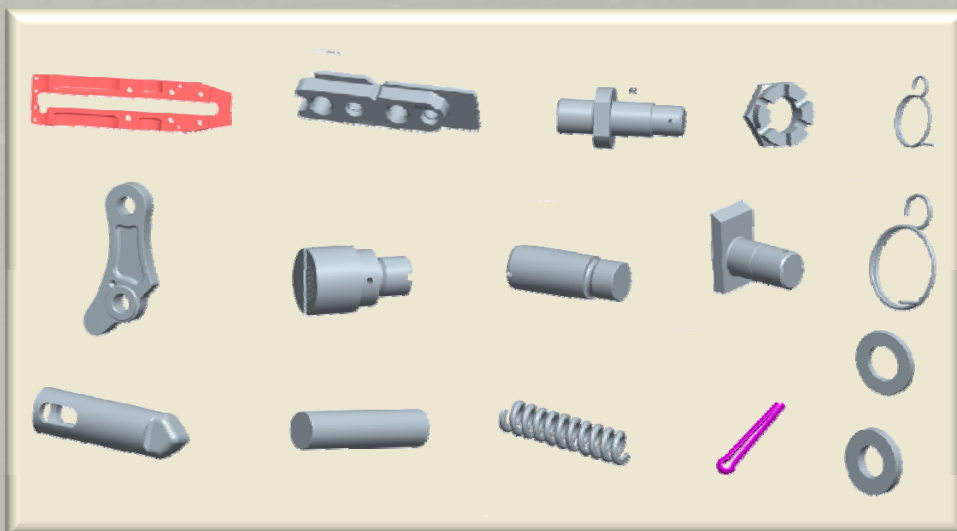

**M2 Slide Assembly,  
Retracting**



**M2 Latch Bolt**